

➤ General Description

This PAN6026EL Dual N-Channel enhancement mode power field effect transistor is the high density trench technology and this advanced technology can provide excellent $R_{ds(On)}$ performance and efficiency for power switching and load switching application., this device also comply with the RoH and Green Product requirement with full function reliability approved.

➤ Feature

- Low Offset (Error) Voltage
- Low-Voltage Operation
- High-Speed Circuits
- ESD Protection
- Low Battery Voltage Operation
- SOT-563 package design

➤ SOT-563

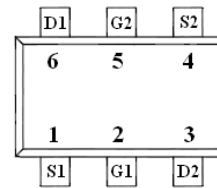

➤ Application

- Drivers: Relays, Solenoids, Lamps, Hammers, Displays, Memories
- Battery Operated Systems
- Power Supply Converter Circuits
- Load/Power Switching Smart Phones, Paggers

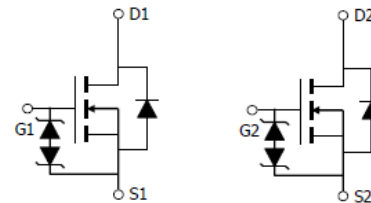

➤ Absolute Maximum Ratings

Parameter	Symbol	Rating	Unit
Drain-Source Voltage	V_{DSS}	60	V
Gate -Source Voltage	V_{GSS}	± 20	V
Continuous Drain Current($T_J=150^\circ C$)	I_D	$T_A=25^\circ C$	0.35
		$T_A=70^\circ C$	0.23
Pulsed Drain Current	I_{DM}	0.65	A
Continuous Source Current(Diode Conduction)	I_S	0.25	A
Power Dissipation	P_D	$T_A=25^\circ C$	0.25
		$T_A=70^\circ C$	0.15
Operating Junction Temperature	T_J	-55/150	$^\circ C$
Storage Temperature Range	T_{STG}	-55/150	$^\circ C$

➤ Electrical Characteristics ($T_A=25^\circ C$ Unless otherwise noted)

Parameter	Symbol	Conditions	Min.	Typ	Max.	Unit
Static						
Drain-Source Breakdown Voltage	$V_{(BR)DSS}$	$V_{GS}=0V, I_D=250\mu A$	60			V
Gate Threshold Voltage	$V_{GS(th)}$	$V_{DS}=V_{GS}, I_D=250\mu A$	1.0		2.0	V
Gate Leakage Current	I_{GSS}	$V_{DS}=0V, V_{GS}=\pm 20V$			3	μA
Zero Gate Voltage Drain Current	I_{DSS}	$V_{DS}=60V, V_{GS}=0V$			1	μA
		$V_{DS}=60V, V_{GS}=0V$ $T_J=85^\circ C$			10	
Drain-Source On-Resistance	$R_{DS(on)}$	$V_{GS}=10V, I_D=0.5A$		1200	2400	m Ω
		$V_{GS}=4.5V, I_D=0.2A$		1700	3000	
Forward Transconductance	g_{FS}	$V_{DS}=10V, I_D=0.2A$		0.2		S
Diode Forward Voltage	V_{SD}	$I_S=0.2A, V_{GS}=0V$		0.75	1.4	V
Dynamic						
Total Gate Charge	Q_g	$V_{DS}=10V, V_{GS}=4.5V$ $I_D=0.25A$		450		pC
Gate-Source Charge	Q_{gs}			110		
Gate-Drain Charge	Q_{gd}			150		
Input Capacitance	C_{iss}	$V_{DS}=25V, V_{GS}=0V$ $f=1MHz$		30		pF
Output Capacitance	C_{oss}			8		
Reverse Transfer Capacitance	C_{rss}			5		
Turn-On Time	$t_{d(on)}$	$V_{DD}=30V, R_L=150\Omega$ $I_D=0.2A, V_{GEN}=10V$		4	10	ns
	t_r			5	15	
Turn-Off Time	$t_{d(off)}$	$R_G=10\Omega$		12	20	ns
	t_f			10	20	

➤ Typical Characteristics

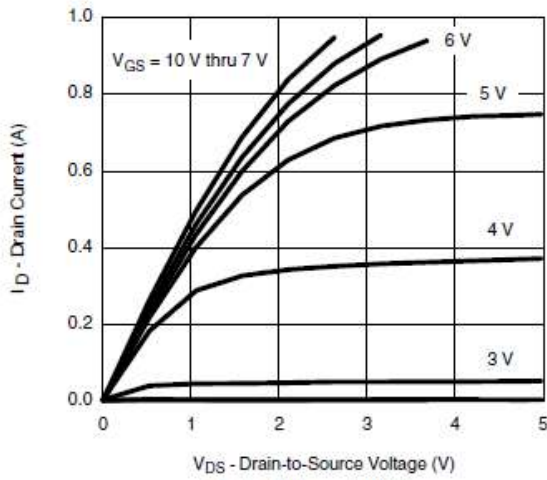

Output Characteristics

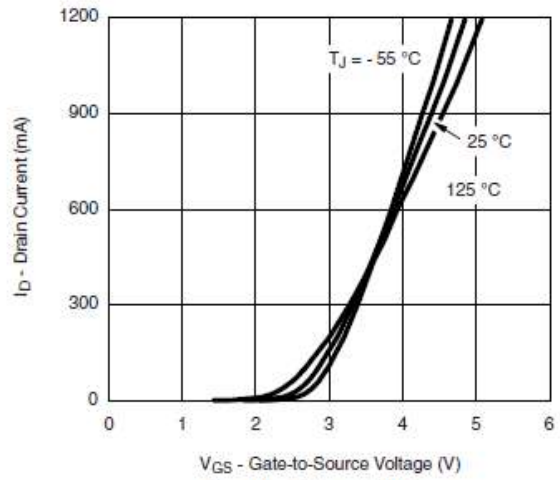

Transfer Characteristics

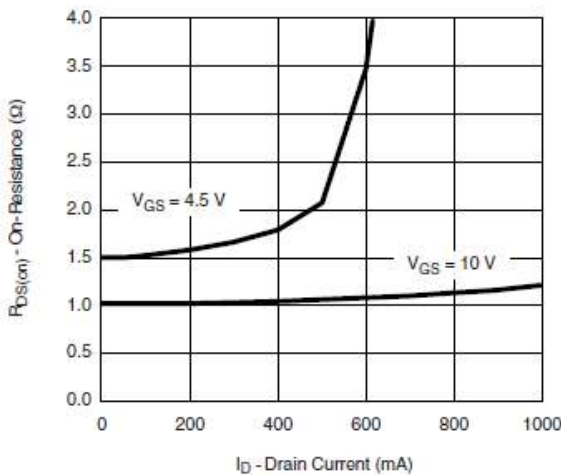

On-Resistance vs. Drain Current

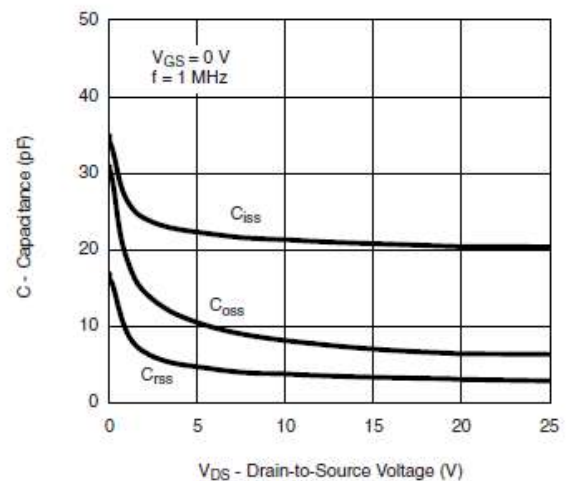

Capacitance

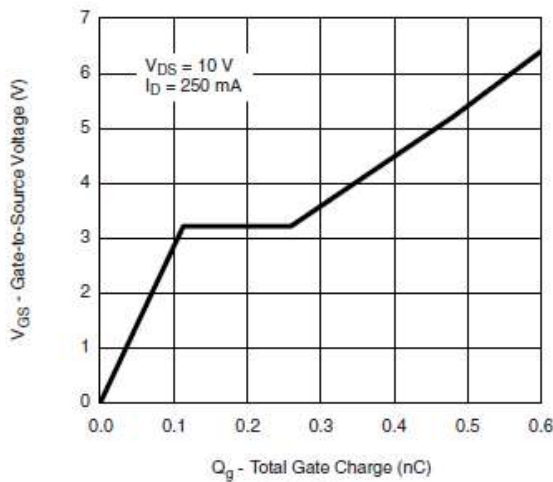

Gate Charge

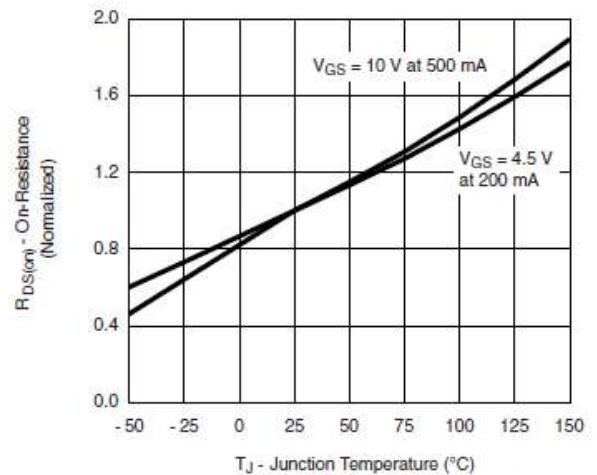

On-Resistance vs. Junction Temperature

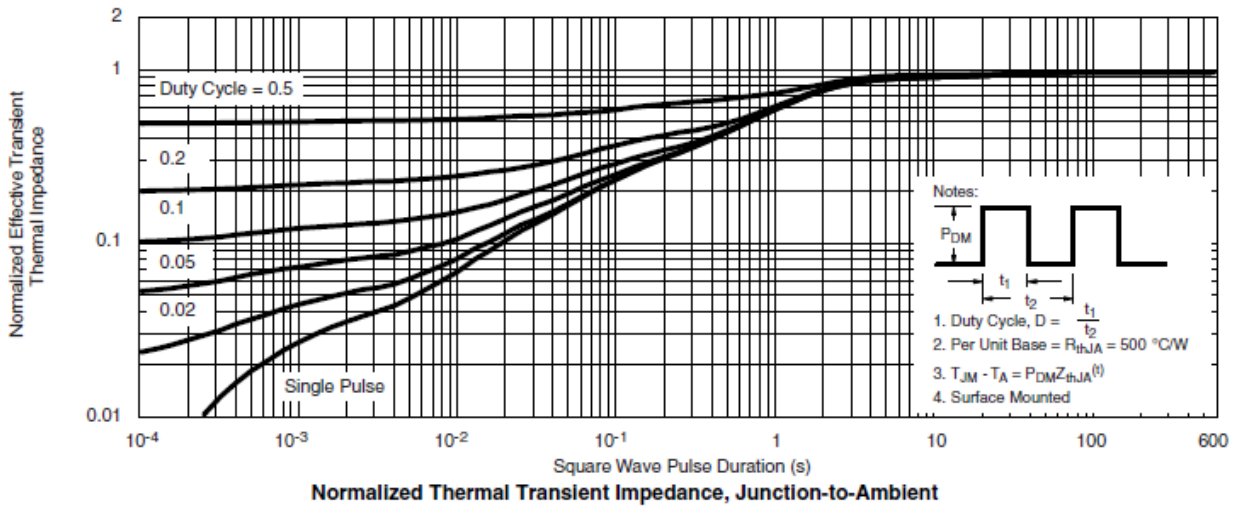
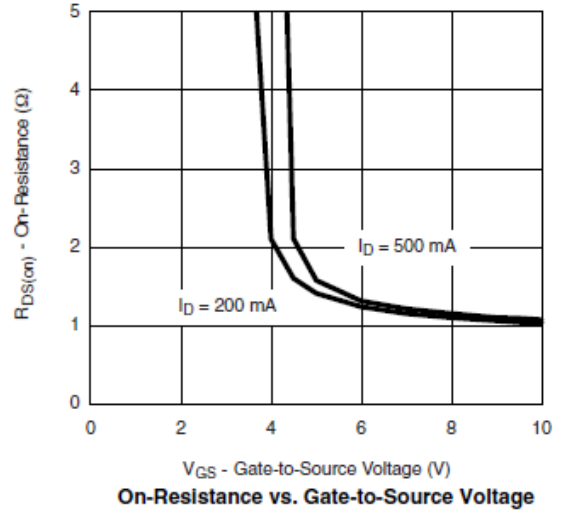
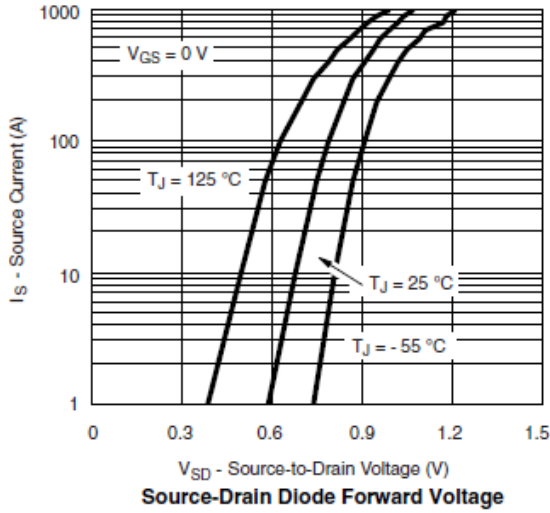

➤ Recommand IR Reflow Soldering Thermal Profile



Profile Feature	Pb-Free Assembly Profile
Temperature Min. (T _{smin})	150°C
Temperature Max. (T _{smax})	200°C
Time (t _s) from (T _{smin} to T _{smax})	60-120 seconds
Average Ramp-up Rate (t _L to t _P)	3°C/second max.
Liquidous Temperature (T _L)	217°C
Time (t _L) Maintained Above (T _L)	60 – 150 seconds
Peak Temperature	260°C +0°C / -5°C
Time (t _P) within 5°C of actual Peak Temperature	30 seconds
Ramp-down Rate (T _P to T _L)	6°C/second max
Time 25°C to Peak Temperature	8 minutes max.

➤ Ordering Information

Part Number	Description	Quantity
PAN6026EL	SOT-563 Reel	3000 pcs

➤ Package Information (SOT-563)

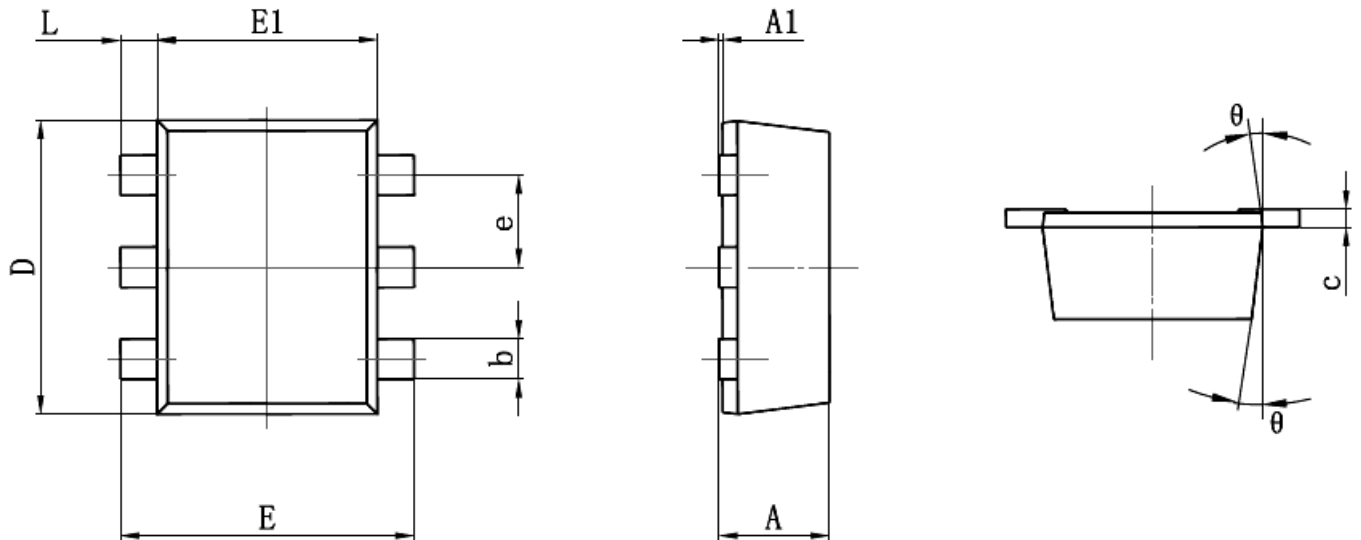

Symbol	Dimenslons In Millimeters		Dimenslons In Inches	
	Min.	Max.	Min.	Max.
A	0.525	0.600	0.021	0.024
A1	0.000	0.050	0.000	0.002
e	0.450	0.550	0.018	0.022
c	0.090	0.160	0.004	0.006
D	1.500	1.700	0.059	0.067
b	0.170	0.270	0.007	0.011
E1	1.100	1.300	0.043	0.051
E	1.500	1.700	0.059	0.067
L	0.100	0.300	0.004	0.012
θ	7 °REF.		7 °REF.	

DISCLAIMER

- The information in this document and any product described herein are subject to change without notice and should not be construed as a commitment by Paceleader, Paceleader reserve the right to make changes to the information in this document.
- Though Paceleader make effort to improve product quality and reliability, Product can malfunction and fail due to their inherent electrical sensitivity and vulnerability to physical stress, it is the responsibility of the customer, when utilizing Paceleader products, to comply with the standards of safety in making a safe design for entire system and to avoid situation in which a malfunction or failure., In developing a new designs, customer should ensure that the device which shown in this documents are used within specified operatingranges.
- The information contained herein is presented only as a guide for the applications of our products. No responsibility is assumed by Paceleader for any infringements of patents or other rights of the third parties which may result from its use.